



SURESPAN

www.surespancovers.com

Aluminium Companionway Over 3m

Approval Drawing
BS 4211:2005 + A1 2008

Ref No.

PRODUCT SPECIFICATION

CODE: SHP/P/A

LADDER

- Stand off brackets: 50.8 x 9.5mm Aluminium Flat Bar
- Aluminium Stiles: 101.6 x 9.5mm Flat Bar
- Treads: Aluminium folded Chequer plate
- Fixings in stainless steel A2 grade
- Finish: Mill finish aluminium
- Grabrail height: 100mm (nom)
- Tread Width: 500mm
- Width Over Handrails: 600mm (nom)
- Handrail height: 1100mm
- Ladder Angle: 75 degree
- Ladder to be fixed into floor & step off
- Platform Deck: Chequer plate
- Platform supported on platform

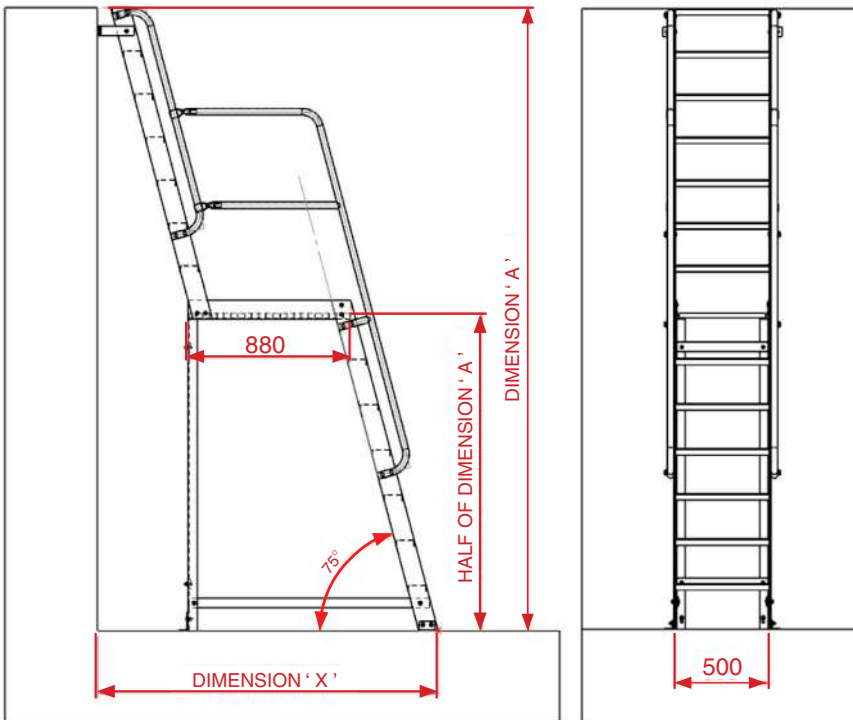

Customer name:	<input type="text"/>	Dimension ' A ':	<input type="text"/>
Project title:	<input type="text"/>	Dimension ' X ':	<input type="text"/>
Order number:	<input type="text"/>	Date:	<input type="text"/>

Comments:

I can confirm the above information is correct and that our order shall be manufactured to these sizes.

Signed:

Leamore Close Leamore Enterprise Park
Walsall, WS2 7NL, West Midlands

Tel: 01922 711185
Email: sales@surespancovers.com



SURESPAN