



SURESPAN

www.surespancovers.com

Aluminium Ladder & Walk through

Approval Drawing
BS 4211:2005 + A1 2008

Ref No.

PRODUCT SPECIFICATION

CODE: SL/WT/A

LADDER

- Marine Grade Aluminium
- Stiles Size 8 Structural Tube (48.3 o/d)
- Surespan SafeGrip serrated rungs
- Fixings are stainless steel
- Aluminium Mill finish. Optional Powder Coating.
- Ladder width: 450mm
- 210mm Stays at maximum 2400 centres

CAGE

- None Fitted. See SLC WT for walk through ladder with cage.

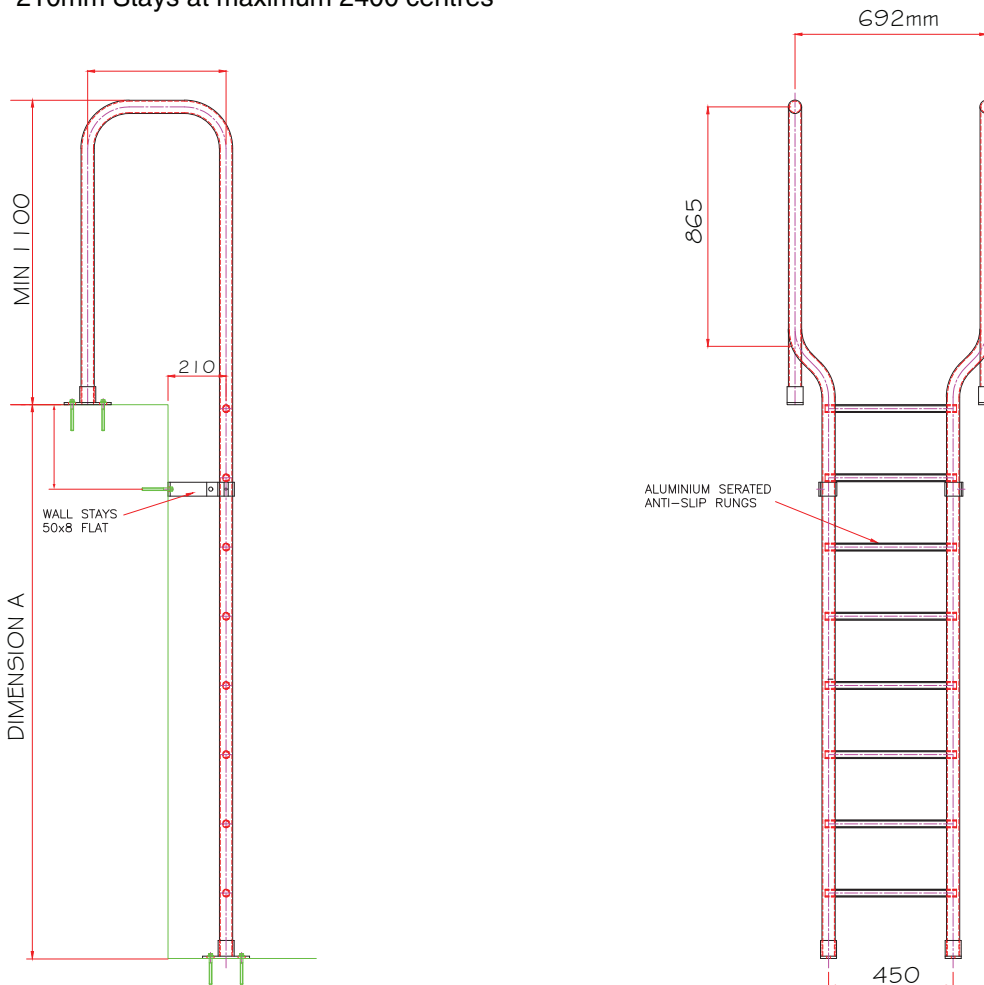

Customer name:

Dimension ' A '

Project title:

Dimension ' B '

Order number:

Date:

Comments:

I can confirm the above information is correct and that our order shall be manufactured to these sizes.

Signed:

